

# NASSAU

## ArteLED

LED's LIGHT range



- No accepted return and loss of guarantee if opening of a power supply or a connector.
- No accepted return and loss of guarantee if the cable provided is cut.
- Never worked under tension.
- The use of gloves is recommended.

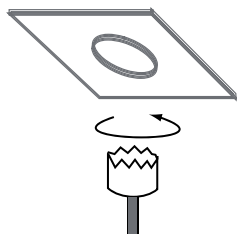

1. To make a Ø176mm hole in the support (ceiling, wall, etc...). Attention, the hole must be clean, without bur.

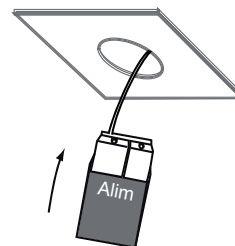

2. To connect the food of the luminary to the network either by the use of a fast connector, or by cable 3G1.5 .

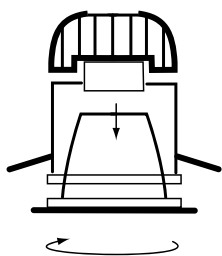

3. To remove the reflectors while rotating it of a quarter of turn.

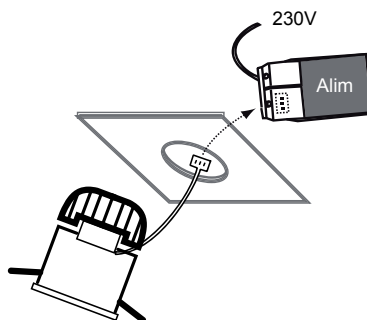

4. To connect the luminary to the food by the means of the connector envisaged for this purpose.

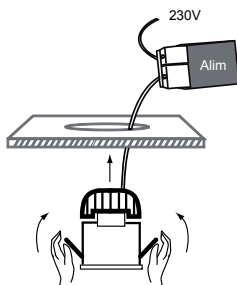

5. To install the luminary in its housing cut out previously by putting pressure on the springs in order to plate them on the arch.

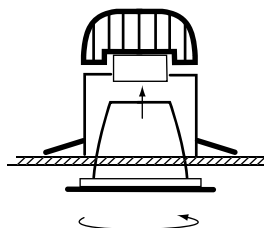

6. To finish, replace the reflectors while turning it of a quarter of turn.